

Structuring Research Efforts in a Primary Care Setting: Mission Possible!

Émilie Taché, Continuous Quality Improvement Specialist, U-FMG Marigot, CISSS de Laval
 Julie Desrosiers, Head of service/Manager, U-FMG Marigot, CISSS de Laval
 Jacinthe Dupuis, Knowledge Mobilization (KMb) Specialist, CISSS de Laval

gmf-u
[DU MARIGOT]

Centre intégré de santé et de services sociaux de Laval Québec

Université de Montréal

Background

The mission of the Marigot University Family Medicine Group (U-FMG) is triple: clinical, academic and research.

The U-FMG is often solicited by various researchers to participate in research projects in primary care.

Better monitoring of the various research projects was needed in order to ensure optimal use of the U-FMG's limited resources.

A dynamic dashboard was developed to follow ongoing research projects on three levels:

- assess the resources required by the proposed projects,
- structure the progress,
- provide feedback on the U-FMG's participation and its impact.

Methods

1. Literature search on the available tools,
2. Comparative analysis of 3 technological tools : MS Planner, Microsoft Project, Miro,
3. Development of the tool architecture (see Dashboard),
4. Pilot project over 1-year period to test and validate the selected tool.

Why MS Planner?

- Real-time access,
- User-friendly,
- Archiving capacity,
- Visualization options (project, calendar, visual clues).

Pilot project

- The tool has been tested with 15 projects so far.
- Improvements have been made throughout different iterations of the tool,
- Results of the pilot project will be presented to the physicians of the U-FMG and researchers.

How we use it?

The Dashboard

Project classified according to its status (in progress, accepted - waiting to start, completed, refused).

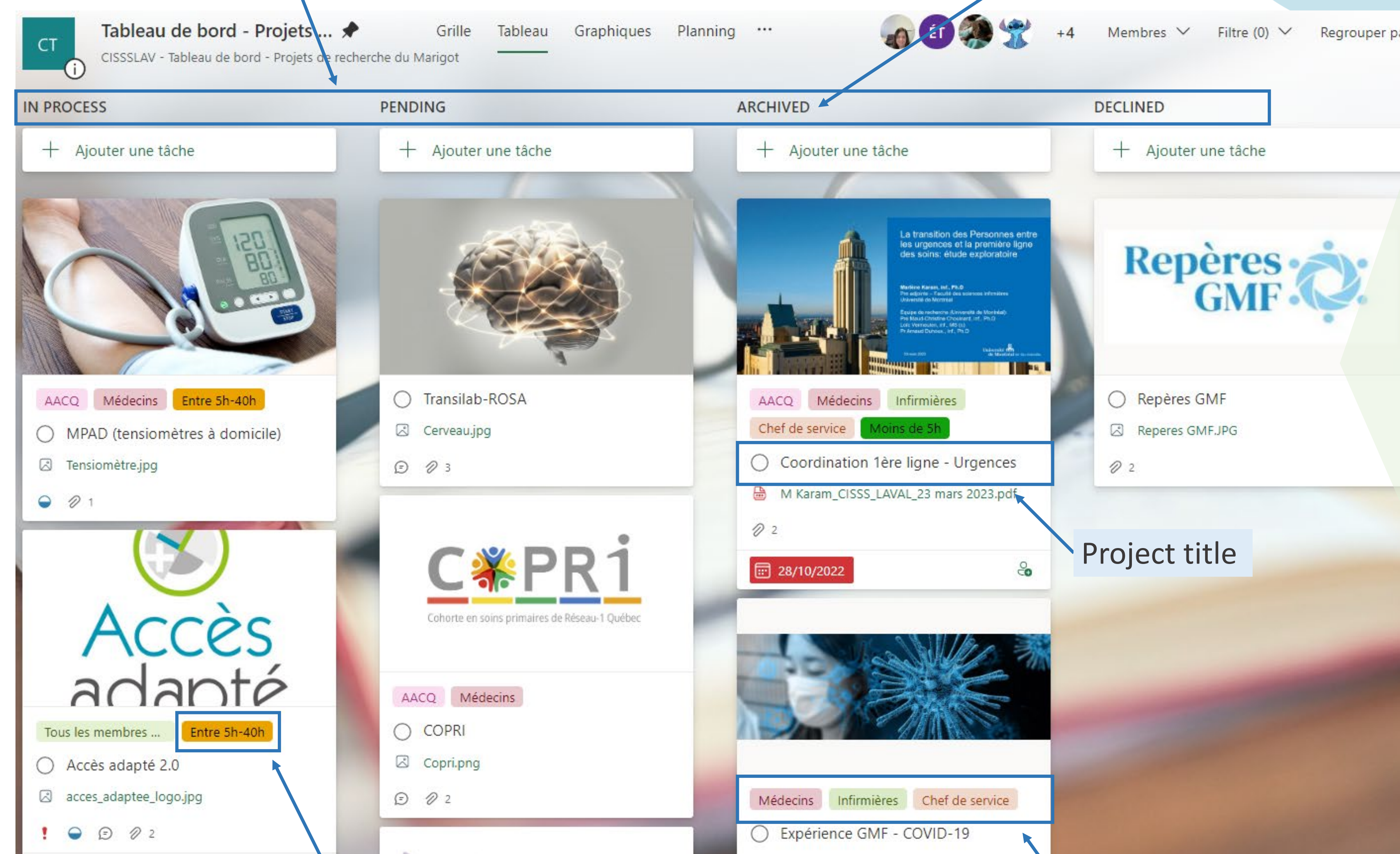

Archived section : allows quick search for specific information about completed or refused projects

Project title

Estimated time required

Professional resources solicited (e.g. nurses, physicians, QI agent)

The Project Card

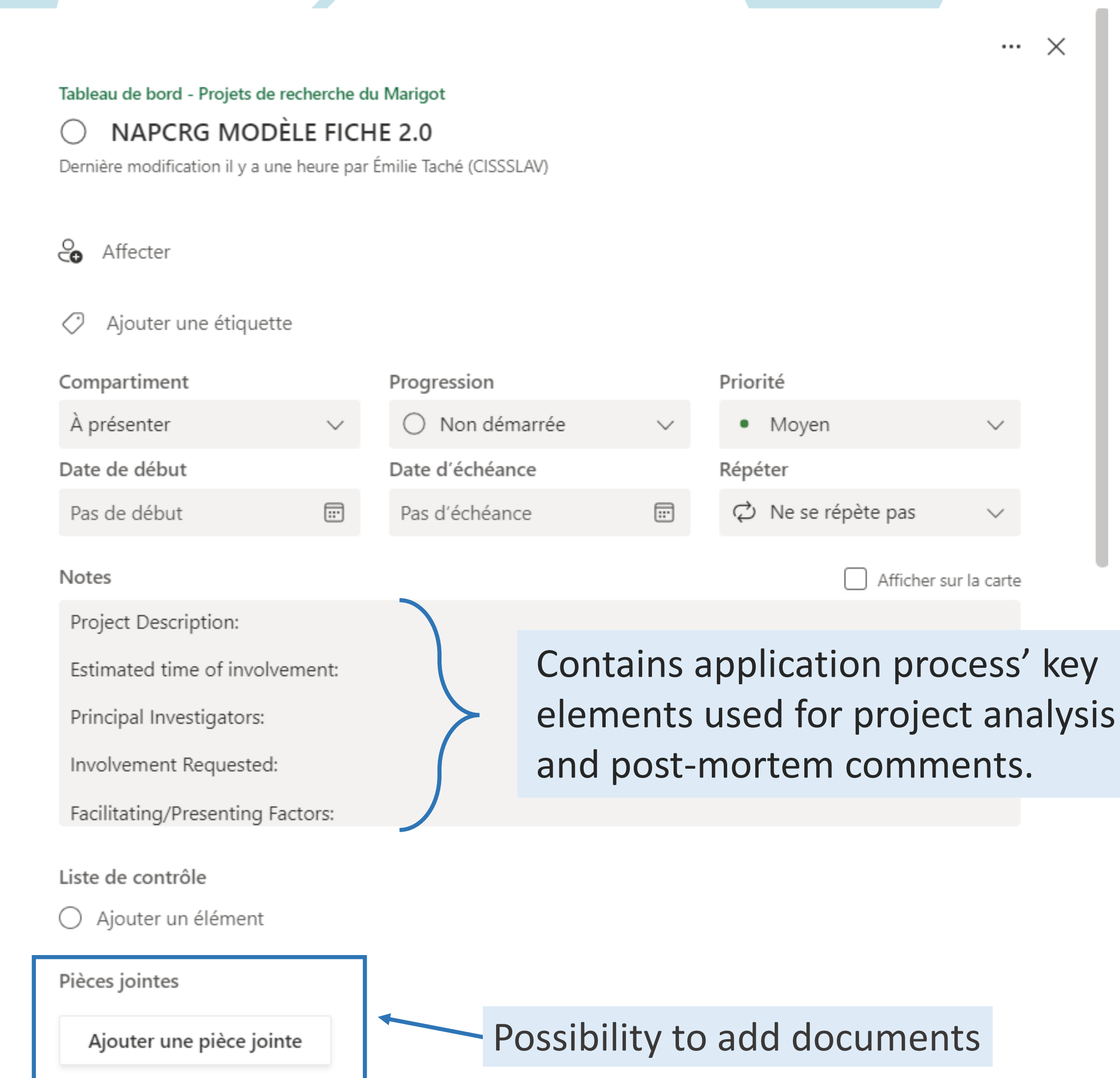

Contains application process' key elements used for project analysis and post-mortem comments.

Possibility to add documents

Benefits

- Structures the U-FMG's analysis and decision to participate in research projects based on its resource capacity,
- Compares resources initially estimated by the researchers with the resource needs once adapted to the U-FMG's reality,
- Offers a detailed assessment of the research activities conducted in the U-FMG.

It's innovative because...?

It **promotes** feedback on the experience within the U-FMG and with the researchers, allowing for better formulated, more precise and coherent requests.

It **improves** key player's understanding of a research project's real needs.

The continuous adaptation of the tool, involving various actors, makes it a **dynamic process**.

It also makes the process more transparent and objective and creates a user friendly 'catalogue' of past, present and current projects.

Future use

Such a dashboard could become a must-have in clinical settings on a larger scale.

Generalizing the use of MS Planner to other types of projects is also possible.

Discussions to adapt the tool to different clinical sectors are underway with other healthcare establishments in the province of Québec, Canada.

Web site:

www.gmfumarigot.ca

Special thanks to:

Marie Authier, PhD and Marie-Eve Lavoie, PhD, RRSPUM research facilitators

